

FORM NO 1.

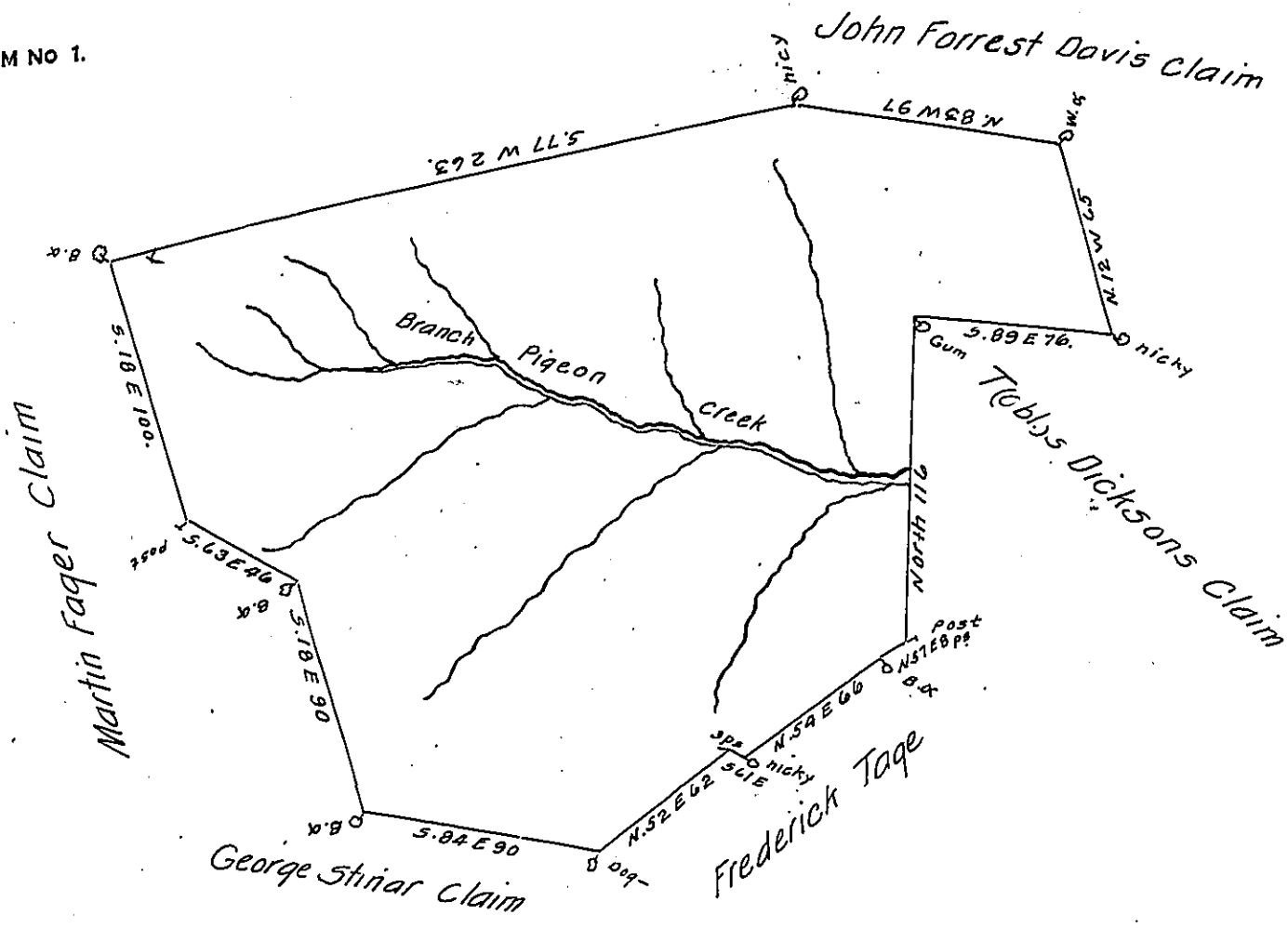

The above is A Draught of Survey made May ye 10th 1785. In pursuance of a ^{Viq & Certificate} ~~Order~~ Granted Thomas Ritchardson. Dated December 14th 1779 - Called - Ritchardson's Folly - Containing 389 Acres & 77 perches & is Situate in Washington County.

A True Cobby

We The Commisioners for Adjusting Claims to Unpatented lands in The County's of Monungahela, Yo hoganian & Ohio do hereby Certify That Thomas Ritchardson is Entitled to four hundred Acres of land in the County of Monungahela on Pigeon Creek - To Include his Settlement made in the Year of Our Lord one Thousand Seven hundred & Seventy four - Also A Right in preerobltion for one Thousand Acres Adjoining Thereto.

Give Under our hands At Redstone Old fort the fourteenth Day of December 1779 - in the fourth Year of the Commonwealth.

test.

Francis Peyton

James Chew. clk / Com.^s

Phil. Pendleton

Joseph Holmes.

IN TESTIMONY that the above is a copy of the original remaining on file in the Department of Internal Affairs of Pennsylvania, made conformably to an Act of Assembly approved the 16th day of February, 1833, I have hereunto set my Hand and caused the Seal of said Department to be affixed at Harrisburg, this twelfth day of March 1908.

Henry Houck

Secretary of Internal Affairs.